



## Gel Pad Repair Patches



# Gel Pad Repair Patches

Gel pads and positioners are used in high-risk environments such as operating rooms and are prone to damage such as tears and punctures from daily use. CleanPatch-P restores to an intact and hygienic state to comply with infection control processes.



Gel Pad Patches



Gel Pad Patch Application

# Gel Pad Patches

CleanPatch®-P repair patch for gel pads and positioners and restores damaged surfaces to an intact and hygienic state in seconds.

## Key Benefits

- Constructed of ultra thin, clear and tough material
- Conforms to curved pressure care surfaces
- Glue seals right to the edges preventing fluid ingress and lift
- Cost effectively extend the life of specialist equipment
- Fully cleanable with hospital grade disinfectants
- Clinically validated and TGA registered

## Product Code

- 10 pack - CPGP-31001

## Patch Dimensions

- 45 x 89mm rectangle patch
- There must be a >25mm margin around the damage site to ensure optimal adhesion.

## Why Buy

The gel pad patch has been designed to repair surfaces of gel positioners commonly used in operating room environments. The rectangle shaped patches are very useful for damage such as tears, punctures and abrasion that can be found on these high-risk surfaces. A cost-effective way of quickly ensuring that damage is checked and doesn't remain an infection risk.

[View how to correctly apply the Gel Pad Patch.](#)



# Gel Pad Patch Application

Instructions to apply the CleanPatch-P to damaged gel pad surfaces that are used in surgical areas.

## Key Benefits

- Use CleanPatch-P on soft gel surfaces that are for pressure reduction and positioning
- Apply on flat areas or over edges (2 dimensions)
- We recommend a maximum of 3 patches per gel pad
- We do not recommend layering multiple patches to cover large areas
- To avoid damaging the precise edge, DO NOT CUT CleanPatch-P

## Related Product Codes

- 10 pack - CPGP-31001

## Why Buy

1. Identify the damaged area and get a patch.
2. Clean the surface as per facility protocol and allow to dry.
3. Remove the white backing from the CleanPatch-P.
4. Hold the edges of the patch and position it over the damage.
5. Apply firm pressure to the patch, out to the edges. Slowly and carefully remove the clear top liner.
6. Clean the patch and surrounding area again as per hospital protocol.

There must be a >25mm margin around the damage site to ensure optimal adhesion.

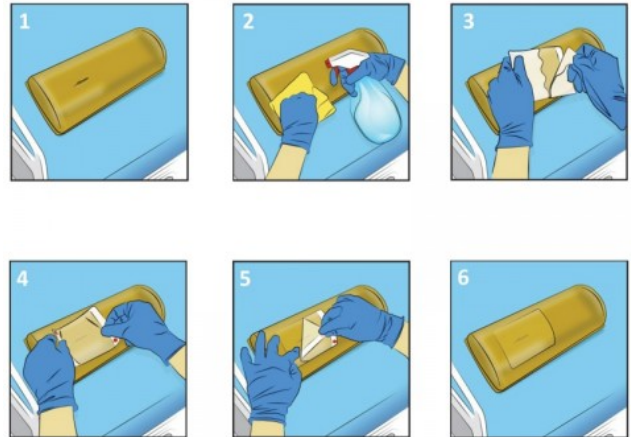

# Notes

-----

-----

-----

-----

-----

-----

-----

-----

-----

-----

-----

-----

-----

-----



# Notes

-----

-----

-----

-----

-----

-----

-----

-----

-----

-----

-----

-----

-----

-----



# Notes

-----

-----

-----

-----

-----

-----

-----

-----

-----

-----

-----

-----

-----

-----



